

- LEGEND**
- LAWN - SUPPLY AND SPREAD EVENLY TO ALL LAWN AREAS NEW TOP SOIL. MINIMUM DEPTH OF NEW SOIL MUST BE 200mm. ALLOW TO SOW AND LAY HYDROLAWN DEPTH SEED.
 - ARTIFICIAL GRASS ON CONCRETE - REFER TO BASELINE DRAWINGS. CONCRETE AND ARTIFICIAL GRASS TO THIS AREA TO BE INCLUDED IN CONTRACT WORKS. SELECTION: TIGERURF TIGERPLAY ARTIFICIAL GRASS.
 - ARTIFICIAL GRASS ON COMPACTED FILL AND SUB BASE TO MANUFACTURERS INSTRUCTIONS INCLUDING FASTENERS, SEAMING TAPE & SMARTFILL SAND. ARTIFICIAL GRASS TO THIS AREA TO BE SUPPLIED & INSTALLED IN MAIN CONTRACT INCLUDING ALL BASE FILL. SELECTION: GRASS 35 ARTIFICIAL GRASS.
 - EXTERIOR PHOTOLUMINESCENT EXIT SIGN. REFER TO POWELL FENWICK FIRE REPORT.



CLIENT
 CHRISTCHURCH INTERNATIONAL AIRPORT LTD

CONSULTANTS
 LEVIN BRADFORD CONSULTING ENGINEERS
 BASELINE GROUP
 POWELL FENWICK CONSULTANTS LTD
 BERN SMITH

LITTLE JETS PRESCHOOL
 795 WAIRAKEI ROAD
 HARVARD PARK
 CHCH INTERNATIONAL AIRPORT

PROPOSED SITE PLAN

SCALE	1:200
DATE	29.08.2021
JOB No.	2015
DRAWN	RM
CHECKED	RM
STATUS	CONSTRUCTION

DRAWING No. **A 0. 01** REVISION **(B)**

1/77 Tiam Street
 PO Box 911
 Christchurch 8140
 New Zealand
 +64 3 777 9860
 info@astudio.co.nz
 www.astudio.co.nz

PROPOSED SITE PLAN
 SCALE: 1:200 @ A2

ADDRESS
 795 WAIRAKEI ROAD
 CNR WAIRAKEI ROAD & PETER LEEMING ROAD
 HARVARD PARK
 CHRISTCHURCH INTERNATIONAL AIRPORT
 CHRISTCHURCH
 NEW ZEALAND

LEGAL DESCRIPTION
 LOT 49 DP 323331

PROPRIETOR
 CHRISTCHURCH INTERNATIONAL AIRPORT LIMITED

CCC ZONE
 SPECIAL PURPOSE AIRPORT ZONE

TERRITORIAL AUTHORITY
 CHRISTCHURCH CITY COUNCIL

MAIN CONTRACTOR TO PROVIDE 150MM MIN DEEP SCREENED TOP SOIL TO SOUTHERN AND EASTERN RAISED AREAS FORMED FROM NEW BUILDING AND CIVIL WORKS AND APPLY LAWN SEED. REFER TO BASELINE DRAWINGS FOR RAISED CONTOUR AREAS.

2 No. RIGID ORANGE 1000 DUCT WITH LONG RADIUS BENDS FOR FUTURE ELECTRIC CAR CHARGING TERMINALS. TERMINATE AND CAP AT SLAB MSB, TERMINATE AND CAP & SEAL AT LANDSCAPE STRIP 150MM ABOVE GL.

LEASE AREAS

PROPOSED SITE AREA	1878.7 M ²
PROPOSED SHARED ACCESS (FORMED & LANDSCAPE)	98.1 M ²
TOTAL SITE AREA	1976.8 M ²
PROPOSED GROUND GFA	497.6 M ²
PROPOSED NORTHERN CANOPY	129 M ²
PROPOSED ENTRY CANOPY	8.9 M ²
PROPOSED SITE COVERAGE (INC CANOPIES & EAVES)	656.8 M ²
PROPOSED TOTAL BUILDING SITE COVERAGE %	34.9 %
PROPOSED LANDSCAPE AREA	557.3 M ²
PROPOSED LANDSCAPING SITE COVERAGE %	28.6 %
IMPERVIOUS SURFACE AREA	1321.4 M ²

LEASE AREAS

CAR PARK AREA	550.2 M ² (EXCLUDING SHARED ACCESS AREA)
FOOTPATHS AREA	93.8 M ²
OUTDOOR WASTE STORAGE COMPOUND (NO ROOF)	7.5 M ²
OUTDOOR PLAY AREA - COVERED & UNCOVERED	436.5 M ² (EXCLUDING 3M LANDSCAPE SETBACK)
CAR PARK SPACES	16
CYCLE SPACES	6

550.2 M ² (EXCLUDING SHARED ACCESS AREA)
93.8 M ²
7.5 M ²
436.5 M ² (EXCLUDING 3M LANDSCAPE SETBACK)
16
6

ENTRY SURFACES TO HAVE A SLIP RESISTANCE COEFFICIENT OF NO LESS THAN 0.4 WHEN TESTED IN ACCORDANCE WITH AS/NZS 3991.1

ROAD MARKINGS - PROVIDE ROAD MARKING TO THE CAR PARK AREAS SHOWN ON THE DRAWINGS. MARKING SHALL CONSIST OF ONE SINGLE WHITE LINE. PROVIDE STANDARD ROAD MARKING TO ACCESSIBLE PARKS AS SHOWN ON THE DRAWINGS INCLUDING ACCESSIBLE PARK SYMBOL.

YELLOW HATCHING.



INDICATES ACCESSIBLE ROUTE

FENCING - REFER TO DRAWING A4.9.04 FOR DETAILS.

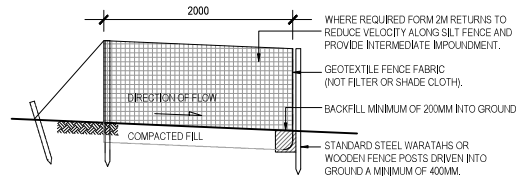
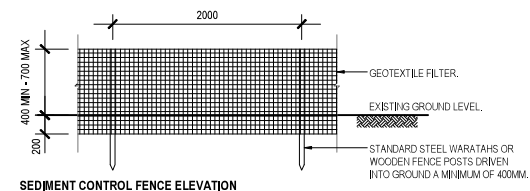

EROSION AND SEDIMENT CONTROL

THE CONTRACTOR SHALL TAKE ALL THE NECESSARY PRECAUTIONS TO CONTROL EROSION AND SEDIMENT RUNOFF FROM THE SITE DURING EXCAVATION & CONSTRUCTION PROCESS.

RUNOFF WATER CONTAINING SEDIMENT OR SILT SHALL NOT DISCHARGE ONTO ANY NEIGHBOURING BOUNDARY OR STREET FRONT.

DOWNPIPE STORMWATER DISCHARGE TO BE CONTROLLED WITH TEMPORARY WATER DIVERSION AWAY FROM STREET SERVICES DURING CONSTRUCTION PROCESS.

EROSION AND SEDIMENT CONTROL CAN BE ACHIEVED BY CONSTRUCTING A TEMPORARY SEDIMENT / SILT TRAP ACROSS THE NEW SITE ACCESS POINT(S) BY ONE OF THE FOLLOWING METHODS

- PLACE WELL COMPACTED HAY BALES INTO A 200MM DEEP TRENCH. BALES ARE TO BE TIED TOGETHER CLOSING ALL GAPS AND ANCHORED TO THE GROUND BY STEEL OR TIMBER STAKES.
- INSTALL PROPRIETARY BIDIM S024 FILTER ROLL OR SIMILAR APPROVED.
- IF AVAILABLE, USE NATURAL SOIL FROM THE SITE TO FORM AN EARTH BUND 1.5M WIDE AND THE SITE UPSTREAM OF THE BUND EXCAVATED TO A MINIMUM DEPTH OF 200MM.

ALONG ALL OTHER BOUNDARIES CONTROL SEDIMENT WITHIN THE SITE BY CONSTRUCTING A SILT FENCE WITH BIDIM A24 GEOTEXTILE OR SIMILAR APPROVED FABRIC. EXCAVATED STOCKPILE MATERIAL CAN BE USED BY THE SAME METHOD TO FORM A SILT FENCE WHERE A NATURAL WATER COURSE WILL FLOW.

REGULAR INSPECTIONS AND MAINTENANCE MUST BE CARRIED OUT TO ENSURE ALL SEDIMENT AND SILT TRAPS ARE IN WORKING ORDER. SEDIMENT AND SILT BUILD UP ARE TO BE REMOVED REGULARLY TO AVOID POTENTIAL OVERFLOW. INSPECTIONS AND MAINTENANCE ARE TO BE CARRIED OUT OVER WEEKENDS, HOLIDAYS AND WHEN SITES ARE NOT FREQUENTED BY THE CONTRACTOR.

STOCK PILES OF CLAY MATERIAL TO BE COVERED WITH IMPERVIOUS SHEET.

ALL GROUND COVER VEGETATION OUTSIDE THE IMMEDIATE BUILDING AREA TO BE PRESERVED DURING THE BUILDING PHASE.

THE CONTRACTOR SHALL SUBMIT THEIR PROPOSED METHOD OF CONTROL FOR EROSION AND SEDIMENT COMPLETE WITH SKETCHES BEFORE COMMENCING ANY SITE WORKS. THE PROPOSED METHOD OF CONTROL IS TO BE DESIGNED BY A SUITABLY QUALIFIED PERSON.



CLIENT
 CHIEFTON AIRPORT INTERNATIONAL AIRPORT LTD

CONSULTANTS
 LEVIN BRADFORD CONSULTING ENGINEERS
 BAILEY GROUP
 POWELL FINNICK CONSULTANTS LTD
 BFM MARTIN

LITTLE JETS PRESCHOOL
 795 WARAKAI ROAD
 HARVARD PARK
 CHCH INTERNATIONAL AIRPORT

SITE SETOUT PLAN

SCALE	1:200
DATE	21/08/2021
JOB No.	2013
DRAWN	RM
CHECKED	RM
STATUS	CONSTRUCTION
DRAWING No.	REVISION
A 0 . 0 2	(B)

1 / 77 Tuam Street
 PO Box 611
 Christchurch 8140
 New Zealand
 +64 3 377 9800
 info@astudio.co.nz
 www.astudio.co.nz

BUILDING TO BE SETOUT BY LICENSED CADASTRAL SURVEYOR.

SITE SETOUT PLAN
 SCALE: 1:200 @ A2

REVISIONS	
A	THRESHOLD RAMP NOTICED FLOOR WALL TYPE AND HEIGHTS WALL TYPE, PART WALLS NOTIFIED
B	ENTRY LOBBY PASSAGE FLOOR CHANGE CHANGE RELEASER FOR CONSTRUCTION

06/02/2021

20/02/2021

ACCESSIBILITY COMPLIANCE TO NZS 4121:2001, 11.1, 900MM WIDE MIN x 540MM MIN, 675MM MIN CLEAR UNDER BENCH, TOP OF BENCH 755MM MAX.
INTERVIEW ROOM WILL HAVE COMPLYING FURNITURE TO PROVIDE COMPLIANCE.

PROVIDE SIGNAGE INSIDE MAIN ACCESS DOOR STATING THAT ASSISTANCE FROM ANY ADULT PERSON IN THE BUILDING IS REQUIRED TO ASSIST THE EXIT OF PEOPLE IN WHEELCHAIRS THROUGH GATE 1. THE SIGN SHOULD ALSO DESCRIBE THE PROCEDURE REQUIRED FOR ABLE-BODIED ADULTS TO OPEN GATE 1.

AUTOSLIDER EMERGENCY SECURITY PANIC BUTTON INTEGRATED INTO RECEPTION COUNTER, CONNECTED TO AUTO SLIDER LOCKING MECHANISM. FIRE EMERGENCY AUTO DOOR PUSH RELEASE TO OVERRIDE SECURITY LOCK. REFER TO A8.02 FOR UNDER SLAB DUCT.

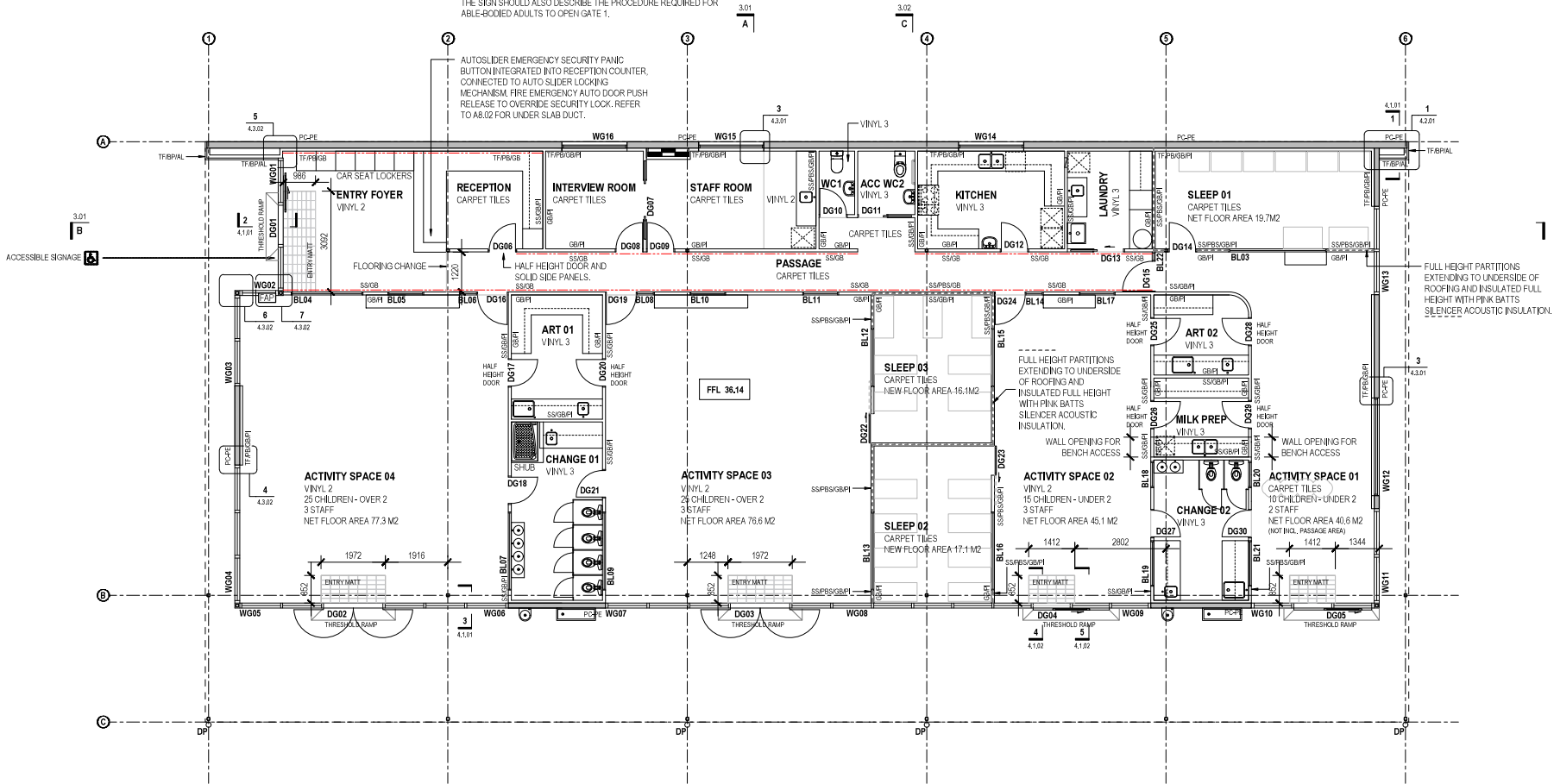

FLOOR PLAN
SCALE 1:100 @ A2

WALL FINISHES

PC-PE PRECAST CONCRETE PANELS, SELECTED PAINT FINISH, LOW VOC, TO EXTERIOR.
TF TIMBER FRAMING
SS STEEL STUDS
BP BUILDING WRAP
PI PAINT INTERIOR, LOW VOC
GB 13MM STANDARD GIB BOARD
GBA 13MM AQUALINE GIB BOARD
FB PINK BATTS THERMAL INSULATION
AL ALUMINIUM COMPOSITE WALL CLADDING.

PINK BATTS SILENCER ACOUSTIC INSULATION TO ALL INTERNAL WALLS.
REFER TO DWG A1.02 FRAMING PLAN FOR SETOUT DIMENSIONS.
REFER TO DWG A1.02 FRAMING PLAN FOR LINTEL SIZES.
REFER TO DWG A1.02 FRAMING PLAN FOR WALL FRAMING SIZES & CRS.
REFER TO DWG A4.7.01 FOR JOINERY.

FLOOR FINISHES

VINYL TYPE 1 DELETED
VINYL TYPE 2 BELGOTEX - WALL T NATURAL OAK
VINYL TYPE 3 BELGOTEX - GERFLOR TARASAFE ULTRA H20, SEASHORE 7325
CARPET TILES BELGOTEX FAST FORWARD BLUE 678, 500x500MM, MONOLITHIC DIRECTIONAL LAYING, DIRECT STICK
ENTRY MATTS x 5 - 15MM SLAB RECESS ADVANCE FLOORING AXIS POLYAMIDE BLACK, TRIM WITH ALF-3515
SKIRTINGS - 150mm HIGH COVED VINYL OR 150mm HIGH CARPET TILES.
REFER TO DETAILS ON DWG. A4.6.01.
- - - - - GIB WALL VINYL SEALER ONLY. LEVEL 4 PLASTER FINISH. FEATURE LINING BY LESSEE

THRESHOLD RAMP - 1:8 THRESHOLD RAMP MAX 450MM LONG IN ACCORDANCE WITH NZS4121:2001 FIGURE 17 REFER TO DETAIL: 2 A4.1.01 FOR SPECIFIC DETAIL.

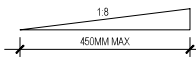

CLIENT
CHRISTCHURCH INTERNATIONAL AIRPORT LTD

CONSULTANTS
LEVER BRADFORD CONSULTING ENGINEERS
BASELINE GROUP
POWELL FENWICK CONSULTANTS LTD
BPM MATRY

LITTLE JETS PRESCHOOL
795 WARAKEI ROAD
HARVARD PARK
CHCH INTERNATIONAL AIRPORT

GROUND FLOOR PLAN

SCALE	1:100
DATE	29.08.2021
JOB No	2013
DRAWN	RM
CHECKED	RM
STATUS	CONSTRUCTION

DRAWING No. A1.01 **REVISION** (B)

1/77 Tean Street
PO Box 681
Christchurch 8140
New Zealand
+64 3 377 9860
info@astudio.co.nz
www.astudio.co.nz

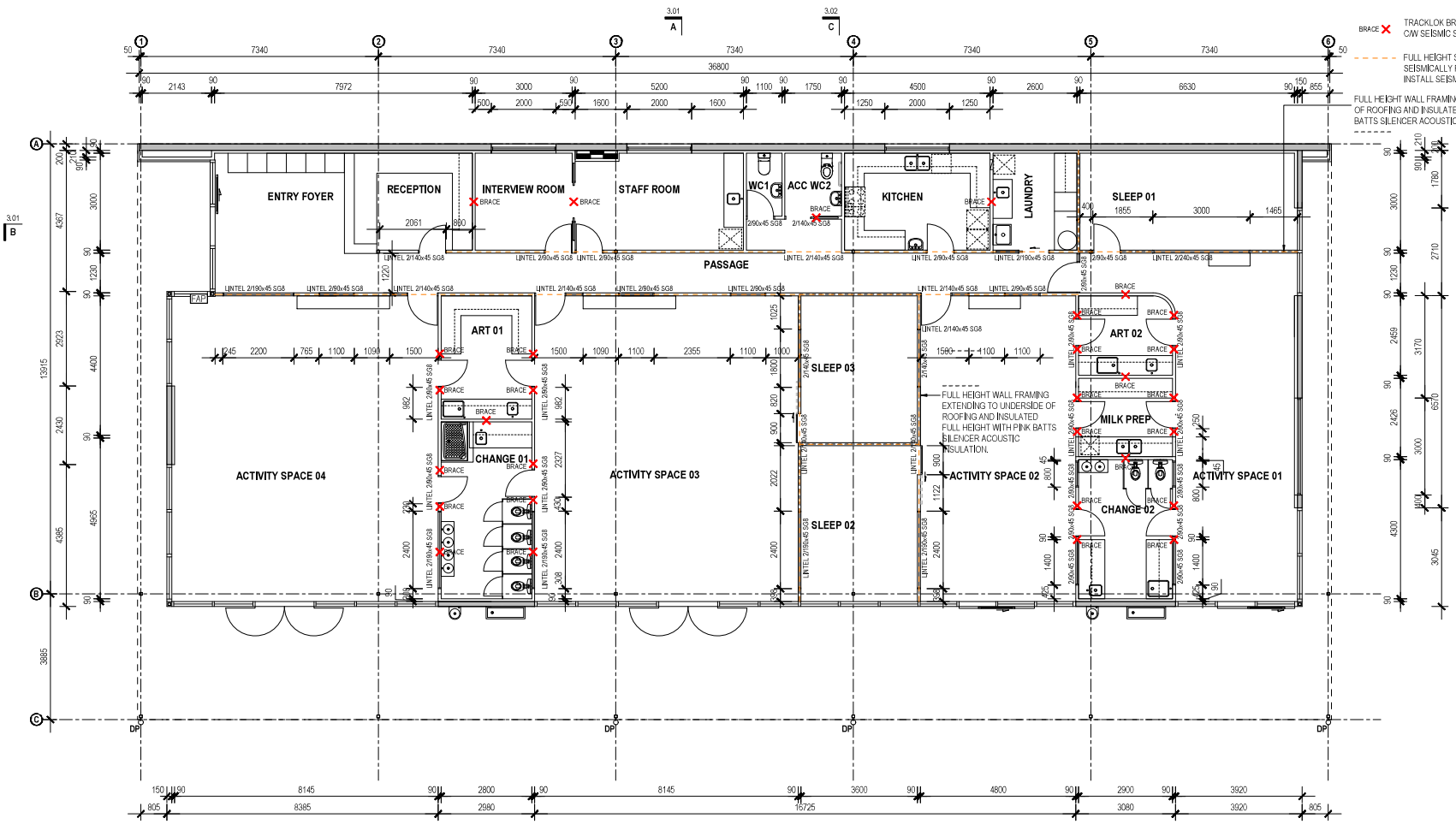

BRACE X TRACKLOK BRACE TO MANUFACTURERS INSTRUCTIONS C/W SEISMIC SLOTTED DEFLECTION HEAD TRACK.
 --- FULL HEIGHT STEEL STUD PARTITION FRAMING SEISMICALLY RESTRAINED TO ROOF STRUCTURE. INSTALL SEISMIC SLOTTED DEFLECTION HEAD TRACK.
 --- FULL HEIGHT WALL FRAMING EXTENDING TO UNDERSIDE OF ROOFING AND INSULATED FULL HEIGHT WITH PINK BATTS SILENCER ACOUSTIC INSULATION.

FRAMING PLAN
 SCALE: 1:100 @ A2

WALL FRAMING

INTERNAL WALL FRAMING UP TO 5.0m HIGH - RONDO 92mm 0.559MT STEEL STUDS @ 600CRS.
 STRAPPING TO PRECAST CONCRETE WALLS - 90x45mm SGB H1.2 TREATED STUDS @ 600CRS.
 PINK BATTS SILENCER ACOUSTIC INSULATION TO ALL INTERNAL WALLS.
 REFER TO TRACKLOK BRACING TECHNICAL MANUAL FOR PARTITION BRACE LOCATIONS AND INSTALLATION.

REFER TO DWG A1.01 FOR WALL AND FLOOR FINISHES.
 REFER TO DWG A1.01 FOR WINDOW AND DOOR NUMBERS.

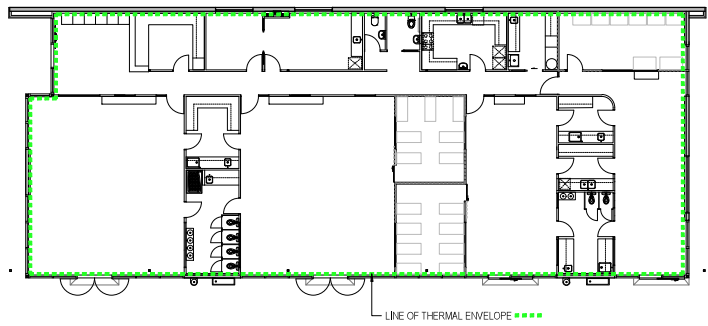

H1 THERMAL ENVELOPE PLAN
 SCALE: 1:200 @ A2

NZS 4243.1: 2007 ENERGY EFFICIENCY - LARGE BUILDING ENVELOPE
 4.2 SCHEDULE METHOD - BUILDING THERMAL ENVELOPE

CALCULATION OF WINDOW TO WALL RATIO (WWR)

AREA OF GLAZING: 156.72m²
 AREA OF WALLS: 422.59m²

WWR: 37.08%
 WWR < 50% THEREFORE, SCHEDULE METHOD TO BE USED

MINIMUM R-VALUES FOR SCHEDULE METHOD (CLIMATE ZONE 3)

ROOF: R19
 WALL: R1.2
 FLOOR: R1.3
 GLAZING: NO REQUIREMENT

R-VALUES ACHIEVED

WALL TYPE A: R1.73
 WALL TYPE B: R1.70
 WALL TYPE C: R1.33
 WALL TYPE D: R2.03
 ROOF: R2.32
 FLOOR: R1.3
 GLAZING: NO REQUIREMENT

SOUTH WALL 189.19m²

WG14: 2m²
 WG15: 2m²
 WG16: 2m²
GLAZING TOTAL 6m²

EAST WALL 80.57m²

WG01: 16.32m²
 WG02: 4.54m²
 WG03: 10.24m²
 WG04: 13.47m²
GLAZING TOTAL 44.57m²

NORTH WALL 117.24m²

WG05/WG06: 24.42m²
 WG07/WG08/WG09: 49.5m²
 WG10: 43.32m²
GLAZING TOTAL 85.08m²

WEST WALL 55.59m²

WG11: 9.04m²
 WG12: 1.95m²
 WG13: 10.65m²
GLAZING TOTAL 21.07m²

WALL TYPE A
 200MM PRECAST CONCRETE WALL, 50MM TIMBER FRAMING WITH STUDS @ 600CRS, 15MM GIB BOARD

WALL TYPE B
 150MM PRECAST CONCRETE WALL, 90x45MM TIMBER FRAMING WITH STUDS @ 600CRS, DWANGS @ 600CRS, C/W R2.4 PINK BATTS INSULATION, 13MM GIB BOARD

WALL TYPE C (WINDOW HEAD)
 60x60MM TIMBER FRAMING WITH STUDS @ 220CRS, C/W R2.4 PINK BATTS INSULATION, 13MM GIB BOARD

WALL TYPE D (WINDOW HEAD)
 250x45MM TIMBER BLOCKING & 50x45MM TIMBER FRAMING WITH STUDS @ 380CRS, C/W R2.4 PINK BATTS INSULATION, 13MM GIB BOARD

CLIENT
 CHRISTCHURCH INTERNATIONAL AIRPORT LTD

CONSULTANTS
 LEVIN BRADFORD CONSULTING ENGINEERS
 BASELINE GROUP
 POWELL FINNICK CONSULTANTS LTD
 BFM PARTNERS

LITTLE JETS PRESCHOOL
 795 WARAKEI ROAD
 HARVARD PARK
 CHCH INTERNATIONAL AIRPORT

FRAMING PLAN

SCALE: 1:100
 DATE: 23/08/2021
 JOB No: 2015
 DRAWN: REM
 CHECKED: RM
 STATUS: CONSTRUCTION
 DRAWING No. REVISION
A1.02 (B)

1/77 Tiam Street
 PO Box 681
 Christchurch 8140
 New Zealand
 +64 3 377 9860
 info@astudio.co.nz
 www.astudio.co.nz